

Ty-Care *exel*/Instructions for use

How to clean the suction catheter

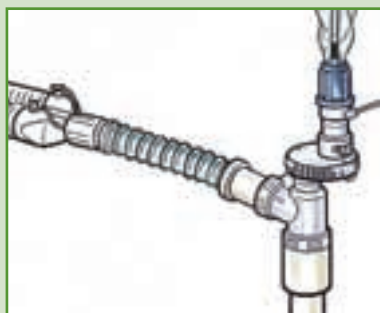

- 1 Ensure patient access valve is in closed position to isolate suction catheter from airway.

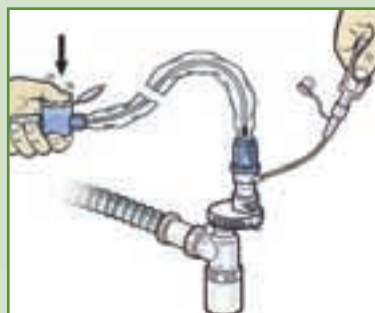

- 2 Connect vial or syringe to flushing port and inject solution while applying suction by pressing control valve.

How to remove suction catheter

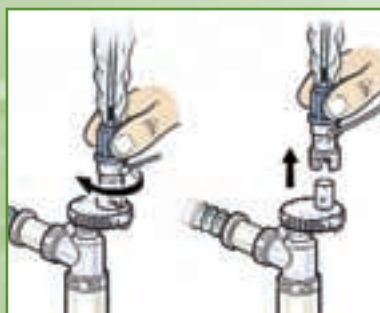

- 1 Ensure patient access valve is in closed position to isolate suction catheter from airway. Rotate suction catheter clockwise and remove it.

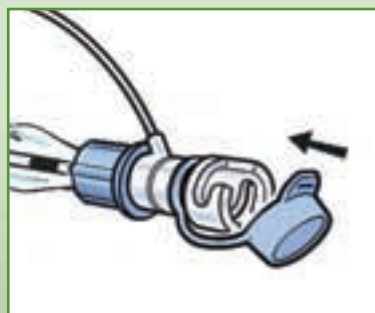

- 2 To protect catheter for possible reuse on same patient, seal using the sterile cap provided.

How to perform bronchoscopy or mucus sampling

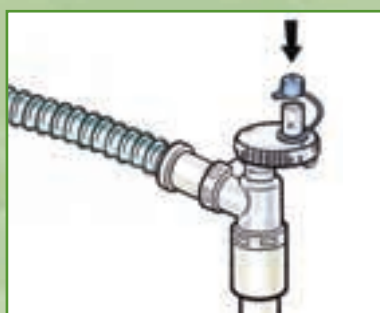

- 1 After removing suction catheter, place self-sealing cap over access port.



- 2 Turn to open position, insert bronchoscope or mucus sampling catheter and perform procedure. Upon completion of procedure, turn to closed position.



Manufactured by: Mallinckrodt DAR,
via G. Bove, 2/4/6/81 - 41037 MIRANDOLA (MO) ITALY
Tel: +39 0535 617901 - Fax: +39 0535 617933

*TY-CARE is a proprietary trademark of a Tyco Healthcare Group LP affiliate.
© 2002 Tyco Healthcare. All rights reserved.

C-BR/TyCIFUEx/GB

tyco
Healthcare



Tyco Healthcare UK Limited
154 Fareham Road
GOSPORT
Hampshire
PO13 0AS
UK
Tel: +44 (0) 1329 224114
Fax: +44 (0) 1329 224390

Tyco Healthcare
Birchwood Court
Montrose Road
P.O. Box 8108
Halfway House
1685 MIDRAND
SOUTH AFRICA
Tel: +27 (0) 11 265 2000
Fax: +27 (0) 11 265 2050

Tyco Healthcare Regional Export
154 Fareham Road
GOSPORT
Hampshire
PO13 0AS
UK
Tel: +44 (0) 1329 224258
Fax: +44 (0) 1329 224086

Tyco Healthcare Norden AB
Gårdsvägen 18
SE-169 67 SOLNA
SWEDEN
Tel: +46 (0) 8 585 605 05
Fax: +46 (0) 8 585 605 06
www.tycohealthcare.com

Tyco Healthcare Nederland BV
Hogeweg 105
5301 LL ZALTBOMMEL
The NETHERLANDS
Tel: +31 418 57 66 00
Fax: +31 418 57 67 93
TycoHealthNed@TycoHealth.com
www.tycohealthcare.nl

Tyco Healthcare Belgium N.V.-S.A.
Generaal de Wittelaan 9/5
B-2800 MECHELEN
BELGIUM
Tel: +32 (0) 15 29 44 50
Fax: +32 (0) 15 29 44 55
tycohealthcare.belgium@tycohealth.com
www.tycohealthcare.com